



## QJ 314 MA Angular contact ball bearings, four-point contact ball bearings

Angular contact ball bearings, four-point contact ball bearings

### Bearing data

[Tolerances](#),

Normal, P6,

[Internal clearance](#),

table

### Bearing interfaces

[Seat tolerances for standard conditions](#),

[Tolerances and resultant fit](#)

## Technical specification

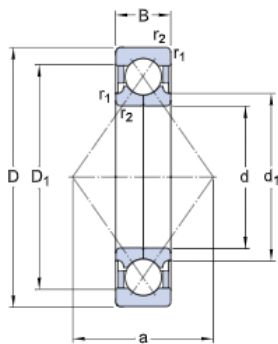

### DIMENSIONS

d	70 mm	Bore diameter
D	150 mm	Outside diameter
B	35 mm	Width
d <sub>1</sub>	≈ 89 mm	Shoulder diameter inner ring
D <sub>1</sub>	≈ 123 mm	Shoulder diameter outer ring/ inner diameter housing washer
a	77 mm	Distance pressure point(s)
r <sub>1,2</sub>	min. 2.1 mm	Chamfer dimension inner ring

### ABUTMENT DIMENSIONS

d <sub>a</sub>	min. 82 mm	Abutment diameter shaft
D <sub>i</sub>	max. 138 mm	Abutment diameter housing
r <sub>a</sub>	max. 2 mm	Fillet radius

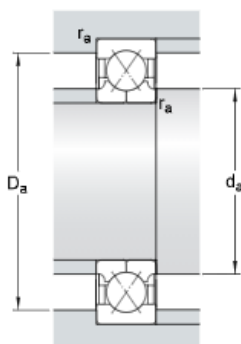

## CALCULATION DATA

C	200 kN	Basic dynamic load rating
C <sub>0</sub>	180 kN	Basic static load rating
P <sub>u</sub>	7.35 kN	Fatigue load limit
	8 000 r/min	Limiting speed
A	0.095	Calculation factor
e	0.95	Calculation factor
X	0.6	Calculation factor
Y <sub>0</sub>	0.58	Calculation factor
Y <sub>1</sub>	0.66	Calculation factor
Y <sub>2</sub>	1.07	Calculation factor

## MASS

	3.15 kg	Mass bearing
--	---------	--------------